

# HP Pull Printing and Access Control Solutions



## Challenge:

Your company needs to save money and increase security by maximizing the effectiveness of its network printers and how documents are printed.

## Solution:

HP and its partners have world-class security solutions that require users to print jobs at the printer using identification badges, swipe cards, proximity cards and keypad codes.

---

### **Increase Security, Decrease Unauthorized Use**

In today's world most organizations are looking at increasing their security levels especially as far as Information Technology (IT) is concerned. One area often overlooked by security strategists is the threat associated with printing documents.

It is essential for organizations to develop a secure printing strategy to avoid fraud, control costs, and have a full audit trail for print jobs. Secure printing solutions help companies comply with standards and raise security levels since they are in line with the "CIA" concept, which stands for confidentiality, integrity and availability.

Indeed, these solutions allow organizations to make sure that only authorized users have access to the print jobs that are meant for them, ensure that no print job is accessed by any person other than the intended recipient, and make print jobs available at multiple networked printers. In addition, secure printing solutions address the issue of accountability for printing transactions sent across a corporate network and add a commercial dimension to an IT solution by making it possible to charge service users or internal departments for using printing devices.\*



### **Pull Printing & Access Control Solutions**

A strategic approach to deployment and operation of printers and multi-function devices in your company increases the efficiency and overall effectiveness of your investment in computer and communication peripherals through better cost management. At the same time you can implement a security strategy for printing that prepares your company for current and future challenges. Together with customers and partners, HP has put together a portfolio of solutions that help companies meet security challenges within their printing environment.

### **Rise to the Challenge**

Implementing a security strategy based on HP's pull printing and secure access solutions makes sense whether your business is in the process of redeploying and consolidating its imaging and printing fleet or involved in cost savings initiatives. They provide solutions for the following challenges:

- **Secure print jobs on their way through the printing infrastructure**—To ensure extreme privacy even inside the Intranet, the print job can be encrypted from its source to the printer.
- **Ensure personal access to printouts on shared printers**—Personal desktop printers are no longer justified by a need for private access to printouts. Any user in your organization can collect a personal and confidential document with an authentication process that requires a user to access a device in order to get a printout. Print jobs are encrypted while waiting to be pulled to any printer and to maintain the confidentiality needed.
- **Ensure only authorized users can access MFP functionalities**—Only authorized users have access to MFPs for copying, faxing, and digital sending, thus eliminating the cost of non-authorized or non-business related usage.
- **Enable printing to any networked printer**—Any user in your organization can collect his/her documents at any device without worrying about which printer the job is sent to. Authentication at the device using a company ID badge, swipe card, proximity card, or keypad allows the user to retrieve print jobs where and whenever they want, eliminating the need for dedicated desktop printers.

### **HP Recommended Partner Solutions**

HP's printing and imaging solutions equip IT professionals with the tools they need to create a comprehensive integrated printer management strategy that will get the most out of resources, increase productivity and provide a reliable print environment that works.

HP and its 3rd party partners have the printing solution for you to optimize your printing environment for your critical business needs. HP works with its partners to provide world class solutions for pull printing and access control.

## SecureJet

SecureJet, developed by JetMobile ([www.jetmobile.com](http://www.jetmobile.com)), is a hardware and firmware solution securing and reporting accurately the usage of the copy, printing, scanning and emailing/digital sending functions of selected HP LaserJet printers and multi-function products (MFPs).

With SecureJet, users authenticate with a badge or PIN code to access printers and MFP functions and release print jobs.

SecureJet requires users to authenticate for access to printers and MFP functions using a PIN code on the front panel, or using a corporate proximity badge, swipecard or smartcard on the SecureJet reader.

Beyond access control, SecureJet offers ultimate secure mobile printing within your company Intranet. Once SecureJet has been installed on the printers, SecureJet drivers offer to secure any printout. The user can designate the specific recipient of a print job, when it expires, and whether or not it should be encrypted using state-of-the-art high-security encryption before leaving the computer of origin. Print jobs can be retained on a Windows server equipped with SecureJet PS, or directly on the target printer hard disk. Nothing further happens until the designated person reclaims the print job by authenticating directly on the device using a PIN code, proximity badge, swipe card or smartcard. If the print job needs to be decrypted, it is done in real time by the print engine while printing, so that even data stored on the server or printer hard disk gets the maximum protection.

SecureJet performs full print jobs tracking even on encrypted flows, with detailed information taken from the print engine. Confidentiality is guaranteed, while print usage can be allocated to users, departments, clients or cases/projects.

### SecureJet Specifications

- Authentication method: up to 1 million users, 4 to 9 digit PIN codes, HID/Mifare/Legic/Hitag 1/EM-Marin Proximity badges, ISO 1/2/3 magnetic badges, smartcards
- Integrated with LDAP and Active Directory through live and cached database access
- Tracks, secures and retains SAP R/3, Oracle, HP/UX, Sun Solaris, Linux Red Hat, Windows and direct-IP print jobs
- Authenticates users and departments for all MFP functions and printer jobs release
- Authentication method: up to 1 million users, 4 to 9 digit PIN codes, HID/Mifare/Legic/Hitag 1/EM-Marin Proximity badges, ISO 1/2/3 magnetic badges, smartcards
- Integrated with LDAP and Active Directory through live and cached database access
- Tracks, secures and retains SAP R/3, Oracle, HP/UX, Sun Solaris, Linux Red Hat, Windows and direct-IP print jobs
- Authenticates users and departments for all MFP functions and printer jobs release

### Supported printers (please visit [www.securejet.com](http://www.securejet.com) for exceptions):

- The solution is available for almost the full range of HP devices and MFPs, including the CLJ4730mfp.
- Secure printing available for Windows, Unix and SAP R/3 clients

Roaming print jobs can be stored on multiple servers and reclaimed from any enabled printer or MFP on the Intranet.



## SafeCom Go

# Safe Com

The SafeCom Go product suite, an application developed by HP partner [SafeCom](#), delivers clever printing solutions embedded into HP LaserJet printers.

SafeCom Go is a robust, scalable and modular solution that helps organizations gain control over their print and copy costs by enabling document security on workgroup printers.

SafeCom Go is a robust, scalable and modular solution that helps organizations gain control over their print and copy costs by enabling document security on workgroup printers. The server side is handled by the proven SafeCom G2 server software.

SafeCom Go turns efficient workgroup printers into personal printers to allow removal of individual desktop devices, optimize office layout and save maintenance costs.

### Pull printing

SafeCom Go offers pull print, copy control, e-mail control and cost tracking. Documents follow users to their choice of printer. Pull print turns efficient workgroup printers into personal printers to allow removal of individual desktop devices so that it optimizes office layout and saves maintenance costs.

### SafeCom Go Specifications

Identification methods:

- User code (1-10 digits + optional 4 digit pincode)
- Magnetic Card (Track 1, 2)
- Proximity Cards: EM41xx, HID, HITAG, Indala, Legic, Mifare, NEDAP, TITAN, UNIQUE and many more upon request
- SafeCom Go ID Kit

### Supported printers (please visit [www.safecom.dk](http://www.safecom.dk) for exceptions):

The solution is available for almost the full range of HP devices and MFPs, including the newest and greatest CLJ4730mfp. For hardware support exceptions, please visit [www.safecom.dk](http://www.safecom.dk)

Other printers are supported by external SafeCom equipment that connects to the printer's network or parallel port.

SafeCom Go turns efficient workgroup printers into personal printers to allow removal of individual desktop devices, optimize office layout and save maintenance costs.

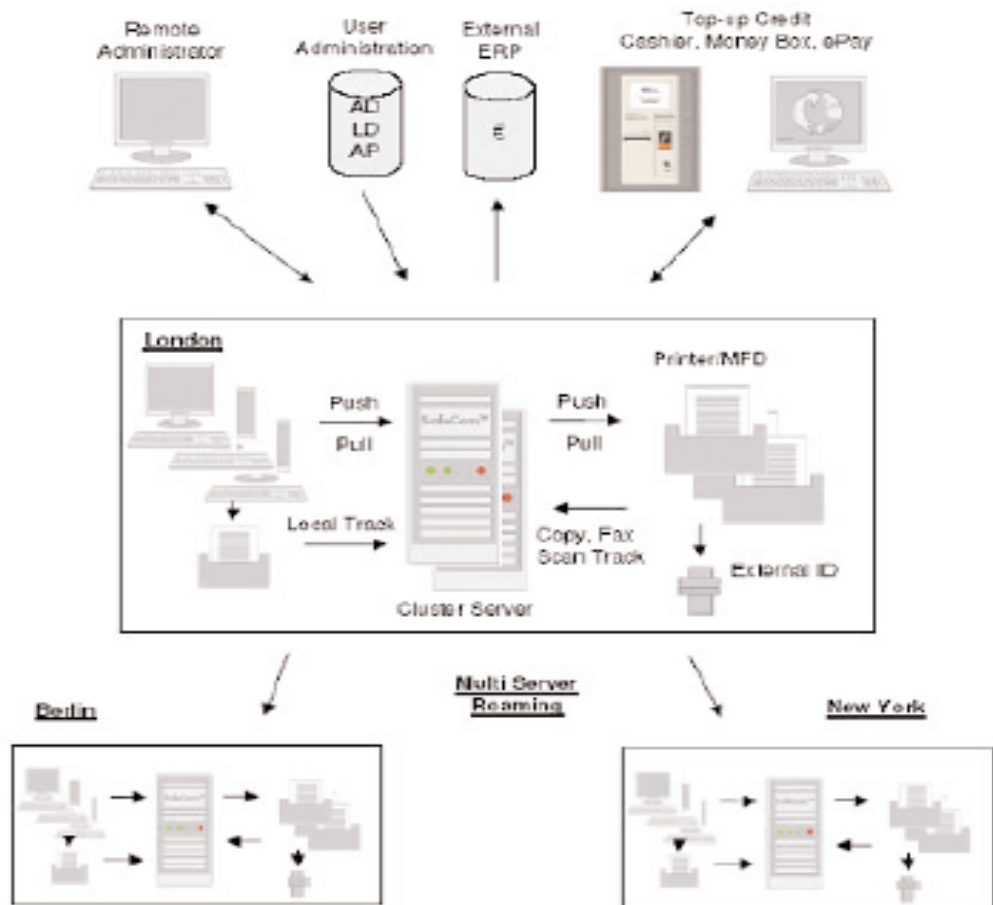



FollowMe solutions ensure control and accountability as well as ensuring print jobs are not lost and roaming between locations is possible with existing ID.

FollowMe, an application developed by HP partner Ringdale ([www.ringdale.com](http://www.ringdale.com)), provides control, accounting and roaming capabilities to copying, faxing, e-mail, printing and scanning functionality available in all copiers, printers and multi-function products (MFPs)

FollowMe works by attaching an authentication device to a printer, copier or MFP. When a user presents an ID at this device then all of his/her current print jobs are released to the printer or MFP. In the case of a copier or MFP, assuming the user has the required permissions, then additional functions such as copying become available.

It is also possible to use FollowMe as a software-only solution to control, monitor and account for printing. For HP MFPs released after September 2004, a fully embedded solution is available providing control of all the printer's functions such as e-mail, fax and scanning.

**FollowMe™ specifications:**

Features:

- Restrict users access to printers and MFPs
- Printing (FollowMe Printing - Interactive Printing)
- Accounting and Auditing
- Centralized Management
- Integrates easily with existing ERP systems such as SAP
- Integrates with existing Identification (ID) card technology from Access Control and Vending systems
- Plug and Play technology
- Simple to use and install with intuitive user interface



## HP and SecureJet Provide Pull Printing and Access Control at German Internet Service Provider

As part of moving the company headquarters to a new building, one German Internet service provider decided to rationalize and optimize the printer/copier/digital sending strategy.

A key request was to have secure, pull printing using the existing company ID badge so that any user could collect his or her document at any MFP in the building.

Their reason for wanting that was to reduce wasted, uncollected paper, and retain personal printing while eliminating desktop printers. The badge also had to control access copy and digital sending functionalities.

The Internet Service Provider decided to implement HP LaserJet 9000LMFP devices equipped with SecureJet, which met all of the above requirements.

## HP Resources for your Pull Printing and Access Control Needs

For more information about pull printing, access control, and other 3rd party solutions, please visit the Global Solutions Catalog located at: [www.hp.com/go/gsc](http://www.hp.com/go/gsc).

---

\* Excerpt from VigiTrust white paper "Secure Printing to Achieve Best Practice Standards,"  
©2003-2005. Additional information is available at: [www.vigitrust.com](http://www.vigitrust.com).

---

© 2005 Hewlett-Packard Development Company, L.P. The information contained herein is subject to change without notice. The only warranties for HP products and services are set forth in the express warranty statements accompanying such products and services. Nothing herein should be construed as constituting an additional warranty. HP shall not be liable for technical or editorial errors or omissions contained herein.

[www.hp.com/go/gsc](http://www.hp.com/go/gsc)

